

Product Name	Panel & Frame	Model No.
Tile Series OLED Panel (Plastic & metal versions)	OLED Panel	HDL-MPL6B/TILE.48
	Frame	HDL-MPL-EC/TILE.48

### Datasheet

Issued: June 8, 2019

Edition: V1.0.0



Figure 1. Tile Series OLED Panel

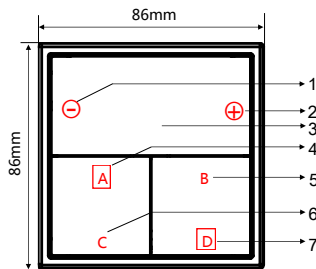

Figure 2. Dimensions - Plastic version

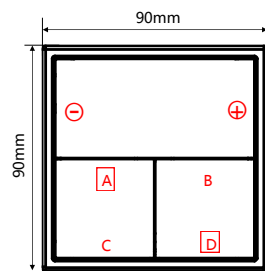

Figure 3. Dimensions - Metal version



Figure 4. Dimensions - Side View

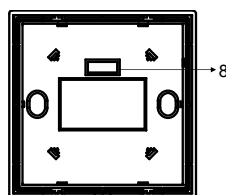

Figure 5. Components - Back View

## Overview

Tile OLED Panel (See Figure 1) is divided into an OLED display and four pushbuttons, enabling controls of air conditioning, fan coil unit, floor heating and ventilation system. Parameters can be set by HDL Buspro Setup Tool or manually set on the panel. The brightness level can be set. The icons and text on the panel support laser labelling.

## Functions

- Built-in temperature sensor and humidity sensor.
- Different pages for air conditioning, floor heating and ventilation system.
- Customizable icons and text
- Adjustable OLED backlight brightness
- Enables controls and settings: Page switching, Air conditioner on/off, Air conditioner mode setting, Air conditioner temperature setting, Air conditioner fan speed setting, Floor heating on/off, Floor heating temperature and mode setting, Floor heating channel selection, Ventilation on/off, Ventilation channel selection, Ventilation fan speed setting, Ventilation mode setting, Backlight brightness setting, Device ID setting, Standby time setting, Language setting.
- Online upgrade via HDL Buspro Setup Tool.

## Important Notes

- The panel should be mounted on the wall box with power interface.
- It is recommended to connect wires in hand-in-hand.
- It is recommended to use dedicated HDL Buspro cable.

## Product Information

### Dimensions - See Figure 2 - 4

1. **"-" Button:** Select previous target, decrease temperature, set standby time and choose device ID.
  2. **"+" Button:** Select next target, increase temperature, set standby time and choose device ID.
  3. **OLED display:** Displays information such as icons and status.
  4. **Confirm button & switch pages:** Used to confirm information and switch pages between air conditioning, floor heating and ventilation.
  5. **Return button & switch modes:** Used to return to the previous page and switch modes of air conditioning and floor heating.
  6. **On/Off button:** Switch on/off of air conditioning, floor heating and ventilation system.
  7. **Fan speed button:** Used to switch fan speed of air conditioning and ventilation system.
  8. **Communication interface:** HDL Buspro bus connector
- Manual setting:** Press button A & D (see Figure 2&3) simultaneously for 2 seconds and enter setting mode to set OLED brightness, standby time, language, etc.

### Components - See Figure 5

### Installation - See Figure 6

- Step 1. Install the wall box in the wall.
- Step 2. Secure the power interface to the wall box with screws.
- Step 3. Install the panel on the power interface.
- Step 4. Install the frame around the panel.

### Horizontal installation - See Figure 7

### Vertical installation - See Figure 8

## Safety Precautions

- The installation and commissioning of the device must be carried out by HDL or the organization designated by HDL. For planning and construction of electric installations, the relevant guidelines, regulations and standards of the respective country are to be considered.
- The device should be wall box mounted. HDL does not take responsibility for all the consequences caused by installation and wire connection that are not in accordance with this document.
- Please do not privately disassemble the device or replace parts, otherwise it may cause mechanical failure, electric shock, fire or body injury.
- Please resort to our customer service department or designated agencies for maintenance service. The warranty is not applicable for the product fault caused by private disassembly.

## Package Contents

Panel\*1 / Datasheet\*1

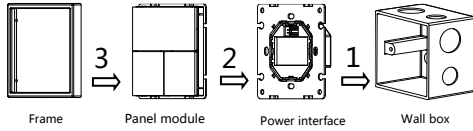

Figure 6. Installation

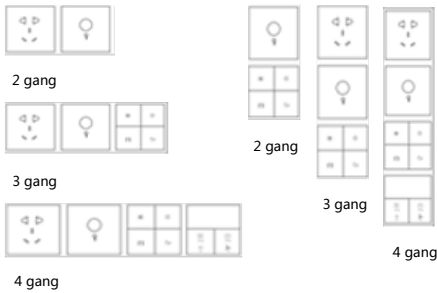

Figure 7. Horizontal installation

Figure 8. Vertical installation

Notes: Metal panels can be installed either horizontally or vertically.  
Plastic panels can be only installed horizontally.

Product name	Frame Types	Gang	Dimensions
2/3/4-gang frames	Metal	2 gang	176*90*10.5(mm)
		3 gang	262*90*10.5(mm)
		4 gang	348*90*10.5(mm)
	Plastic	2 gang	172*86*10.5(mm)
		3 gang	258*86*10.5(mm)
		4 gang	344*86*10.5(mm)

## Technical Data

### Basic Parameters

Working voltage	12~30V DC
Working current	16mA/24V DC
Communication	HDL Buspro
Cable diameter of Buspro terminal	0.6-0.8mm

### External Environment

Working temperature	-5°C~45°C
Working relative humidity	≤90%
Storage temperature	-20°C~60°C
Storage relative humidity	≤93%

### Specifications

Dimensions	Plastic version: 86×86×11(mm) Metal version: 90×90×11(mm)
Net weight	Plastic version: 69g Metal version: 107g
Housing material	Plastic version: Flame retardant PC Metal version: Aluminum alloy
Installation	Wall box (See Figure 6)
Protection rating (Compliant with EN 60529)	IP20

### Name and Content of Hazardous Substances in Products

Components	Hazardous substances					
	Lead (Pb)	Mercury (Hg)	Cadmium (Cd)	Chromium VI (Cr (VI))	Poly-brominated biphenyls (PBB)	Poly-brominated diphenyl ethers (PBDE)
Plastic	o	o	o	o	o	o
Hardware	o	o	o	o	-	-
Screw	o	o	o	x	-	-
Solder	x	o	o	o	-	-
PCB	x	o	o	o	o	o
IC	o	o	o	o	x	x

The symbol “-” indicates that the hazardous substance is not contained.

The symbol “o” indicates that the content of the hazardous substances in all the homogeneous materials of the component is below the limit requirement specified in the Standard IEC62321-2015.

The symbol “x” indicates that the content of the hazardous substance in at least one of the homogeneous materials of the part exceeds the limit requirement specified in the Standard IEC62321-2015.

## HDL Buspro Cable Guide

HDL Buspro	HDL Buspro Cable
DATA+	Yellow
DATA-	White
COM	Black
24V DC	Red

#### Technical support

E-mail: support@hdlautomation.com

Website: <https://www.hdlautomation.com>

©Copyright by HDL Automation Co., Ltd. All rights reserved.  
Specifications subject to change without notice.