

⚠️ Attention:

- Welcome to use 230 Dry Contact Curtain Motor 220V AC.
- Please read this instruction carefully before installing or using the motor.
- The motor should not be used in outdoor or high temperature environment, and should avoid direct sunlight.
- Don't crash or drop any part. Don't dismantle or repair any part by yourself.
- All parts of the motor are designed with self-lubrication, please don't use external lubricant.
- The motor will run slowly at the first time to record the length of the track system. Then it comes to normal speed when it works at the second time.
- If the motor has been used in other tracks before, the curtain may not stop as expected position in another track, because the motor recorded the previous limit information. In this case, you have to delete the limits.
- The setting limit and intermediate point will automatic be deleted when the user operate direction change.

Main features

- Anti-sinking and waterproof design, IP41.
- Quiet, DC motor, unique compact and neat motor design.
- Patented mechanical clutch design. Full automatic setting of the limits.
- Built-in radio receiver, with dry contact port.

Operation buttons and interfaces

- [Dry contact interface] For external remote controller
- [LED light] Working status indicator of power on, matching code, operation.
- [Program button] Remote control setting
- [Power] 100-240V AC
- [Wireless remote] RF433

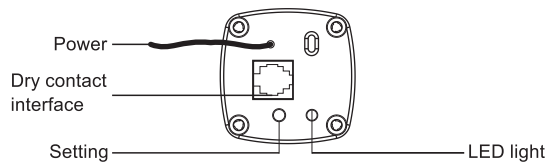

Specification

Model	230
Rated input voltage	AC100-240V (50/60Hz)
Rated input current	1.2A
Motor rotate speed	118rpm
Motor torque	1.0N.m
IP rating	IP41

Operation functions

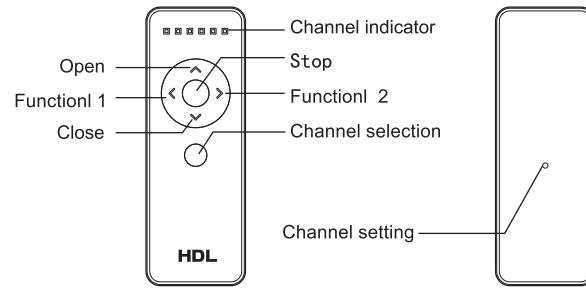

- Open the curtains: Press [OPEN] button on the remote control.
- Stop opening the curtains/Stop closing the curtains: Press [STOP] button on the remote control.
- Close the curtains: Press [CLOSE] on the remote control.
- Use hand-start control function: Simultaneously press [STOP] and [OPEN] till the LED light on, and press [SETTING] button, then this function is opened.
- Cancel hand-start control function: Simultaneously press [STOP] and [CLOSE] till the LED light on, and press [SETTING] button on the motor, then this function is canceled.
- Delete the limit: Simultaneously press [STOP] and [CHANNEL SETTING] button on the back of the remote control.
- Change running direction:
 - Press [SETTING] button on the motor till the LED light on, the motor enter into setting codes status.
 - Simultaneously press [STOP] and [CHANNEL SELECTION] button on the remote control, and press [SETTING] button on the motor, then the motor enter into setting codes status.
- Operate the motor to set codes:
 - Press [SETTING] button on the motor till the LED light on.
 - Press the [CHANNEL SETTING] on the back of the remote control, then the LED light on the motor flash.
 - In 10 seconds, press the [SETTING] button on the motor, then the motor finish setting codes.
- Delete remote control channels
 - Press [SETTING] button on the motor till the LED light on.
 - Press [SETTING] button on the motor again till the LED light off, the motor finish deleting remote control channel while running once.

Control modes

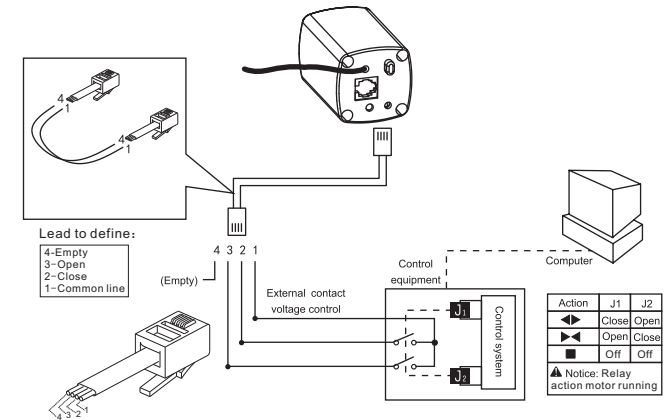

Motor installation

Figure 1

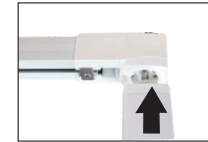
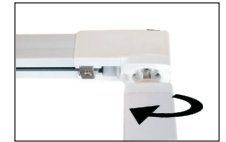

Figure 2



- Put the motor shaft into the drive unit, as shown in Figure 1.
- Rotate the motor 90 degrees counterclockwise and make it parallel with the track, as shown in Figure 2.

Motor dismantlement

Figure 1



Figure 2

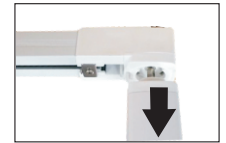

- Press and hold the clipping lock and push it up, as shown in Figure 1.
- Rotate the motor 90 degrees clockwise and take out the motor, as shown in Figure 2.

Motor dismantlement

Malfunction	Solution
Motor stops midway	Delete all limits.
	Check if the track of the fabric is blocked.
Remote controller can't control the motor	Please confirm that the motor have set codes with the current channel of the remote controller
	Check if the operation in the range of the control modes.
	Check the power supply.
The motor can't run by hands	Check if the track of the fabric is blocked.
	Use hand-start control function.
The motor runs without any operation	Please check the remote control whether it's pressed by heavy stuff or not.

Warranty

Series motor carry a five years warranty from the date of invoice. Factitious damage and dismantlement are exclusive of warranty.

HDL[®]

230

*Dry Contact Curtain Motor 220V AC
Instruction Manual*

CE



HDL Automation Co., Ltd.
No. 86 Lianhua Road West, Shilou Town, Panyu District,
Guangzhou, China (Post Code: 511447)
E-mail: support@hdlautomation.com
Website: <https://www.hdlautomation.com>

Please read the specification carefully before installation or use.
Please install and adjust the product by professionals.