

- HDL-XC62-KV Rhythmus Ceiling Speaker XC62
律动系列吸顶音箱XC62
- HDL-NS83-KV Rhythmus Ceiling Speaker NS83
律动系列吸顶音箱NS83
- HDL-NW82-KV Rhythmus Wall Speaker NW82
律动系列墙壁音箱NW82
- HDL-SIW82 Rhythmus Wall Speaker SIW82
律动系列墙壁音箱SIW82

Datasheet
产品说明书

Issued: March 26, 2018
发布: 2018年03月26日
Edition V1.0



Figure 1 / 图 1



Figure 2 / 图 2



Figure 3 / 图 3

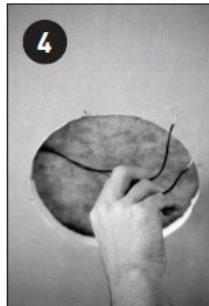

Figure 4 / 图 4

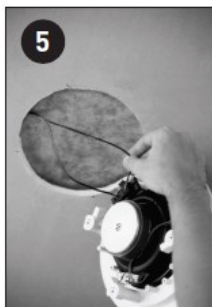

Figure 5 / 图 5



Figure 6 / 图 6

Overview

Rhythmus speakers are manufactured with high quality components and engineered to deliver top quality sound performance. These high performance flush mounting loudspeakers have been designed to give you many years of trouble free listening enjoyment. They comes with an easy to install mounting system, with frame and grilles that can be painted to match your room decoration.

Features

- 2-way full-frequency sound design ;
- Has tweeter (except HDL-SIW82);
- Has woofer (except HDL-NS83-KV) ;
- Supports high tone protection ;
- Contemporary low profile grille design.

Important Notes

- Be certain that there are no electrical wires, water pipes, or heating ducts in the planned installation area before you start drilling or cutting into the ceiling. If there is an electrical outlet nearby, turn off the circuit breaker to avoid possible injury.
- If no insulation is present, you may want to consider loosely filling the cavity with dacron, or fiberglass insulation to provide some acoustic dampening, improving overall sound quality especially in the low or bass frequencies.
- Do not over-tighten the screws as damage can result to the speaker's frame. Place grille on speakers to complete the installation.

Product Installation

Installation tools:

- Jig saw or wall board saw
- Star shaped screwdriver
- Level
- Coat hanger or about 1.5 feet (40cm) of solid core wire
- Speaker cable
- Drill
- Measuring tape
- Wire strippers
- Wire snake (fish)
- Electronic stud finder (Optional)

Speaker installation—See Figure 1-6

1. Check for obstructions. Once you have determined the ideal location, tap the wall or ceiling with your knuckles or use an electronic stud finder to check for studs or beams to be avoided.
2. Drill a hole in the centre of the traced outline. Cut approximately 1' (30cm) of coat hanger wire and bend it to a right angle in the middle. Insert in the hole and rotate to check for wires, pipes, studs or other obstructions.
3. Carefully cut out the speaker hole with a fine toothed key hole saw or drywall saw. Remove the cutaway and compress the insulation if any.
4. & 5. Drag the speaker cable from the receiver or power amplifier behind the wall or ceiling and out of the speaker hole, allowing 2' (60cm) of slack to protrude. Strip about 3/8"(1cm) off the ends of the speaker wires and connect to the speaker terminals.
6. Ensure the "Dog Ears" are fully extended and insert the speaker in the wall or ceiling. Level and tighten the screws on the speaker frame to fix the speaker in place.

Safety Precautions

- The installation and commissioning of the device must be carried out by HDL or the organization designated by HDL. For planning and construction of electric installations, the relevant guidelines, regulations and standards of the respective country are to be considered.
- HDL does not take responsibility for all the consequences caused by installation and wire connection that are not in accordance with this specification.
- Please do not privately disassemble the device or change components, otherwise it may cause mechanical failure, electric shock, fire or body injury.
- Please resort to our customer service department or designated agencies for maintenance service. The warranty is not applicable for the product fault caused by private disassembly.

Package Contents

- HDL-XC62-KV(with grille)*2 / Datasheet*1
- HDL-NS83-KV(with grille)*1 / Datasheet*1
- HDL-NW82-KV(with grille)*2 / Datasheet*1
- HDL-SIW82(with grille)*1 / Datasheet*1

产品概述

律动系列音箱是采用高质量的部件制造的, 为用户提供最优质的声音性能。这些高性能的嵌入式安装音箱可为您带来长久无忧的听觉享受。它们配备了一个易于安装的安装系统, 框架和网罩可以涂上与您的房间装饰相匹配的涂层颜色。

特性

- 二音路全频设计
- 高音单元(HDL-SIW82除外)
- 低音单元(HDL-NS83-KV 除外)
- 高音保护
- 现代低调的网罩设计

注意事项

- 在开始钻孔或切割天花板之前, 请确保在计划安装区域内没有电线、水管或加热管道。如果附近有电源插座, 请关闭断路器以避免可能的伤害。
- 如果没有绝缘存在, 你可能想考虑用涤纶松散填充的腔体, 或用玻璃纤维绝缘, 以提供一些声音阻尼, 改善整体的声音质量, 特别是在低或低音频率。
- 不要过度拧紧螺丝, 会损坏音箱的框架。在音箱上放置网罩则完成安装。

产品安装

安装工具:

- 夹具锯或墙锯
- 星形螺丝刀
- 水平仪
- 衣架或约1.5英尺(40厘米)的实心铁丝
- 音箱电缆
- 电钻
- 卷尺
- 电线剥皮钳
- 铁丝蛇(鱼)
- 电子找钉器(可选)

音箱安装—见图 1-6

1. 检查障碍物。一旦你确定了理想的位置, 用你的指节轻敲墙壁或天花板, 或使用电子找钉器检查以避免螺栓或横梁。
2. 在描线的中心钻一个孔。切割约1' (30厘米)的衣架铁丝, 并将其在孔的中间弯曲成一个直角。将其插入孔并旋转以检查是否有电线、管道、螺栓或其他障碍物。
3. 小心地用细齿钥匙孔锯或干墙锯切出音箱孔。移除切除部分隔板, 若有则压缩绝缘层。
4. & 5. 将音箱电缆从接收器或功率放大器拖出墙或天花板后, 并从音箱孔拖出, 允许2' (60厘米)的松散线缆, 可使其凸出。从音箱电线的两端剥离线缆皮约3/8" (1厘米), 并连接到音箱终端。
6. 确保“狗耳”完全伸展, 并将音箱插入墙壁或天花板。将音箱框架上的螺丝调平和拧紧以固定音箱的位置。

安全警告

- 本设备的安装及调试工作必须由我司或我司指派的机构进行。其电气安装的计划 and 施工, 必须遵守当地相关的安全标准和法规。
- 未按照本说明书进行安装及接线方式的, 所造成的一切后果皆与我司无关。
- 请不要私自拆装或更换零部件, 否则可能会导致机械故障、电击、火灾或身体伤害。
- 请将一切维修工作交由我司售后部门或指定机构进行, 本产品的保修范围不适用于因用户拆卸产品而导致的故障。

装箱清单

- HDL-XC62-KV(附网罩) *2 / 说明书*1
- HDL-NS83-KV(附网罩) *1 / 说明书*1
- HDL-NW82-KV(附网罩) *2 / 说明书*1
- HDL-SIW82(附网罩) *1 / 说明书*1



HDL-XC62-KV

Figure 7 / 图 7



HDL-NS83-KV

Figure 8 / 图 8



HDL-NW82-KV

Figure 9 / 图 9



HDL-SIW82

Figure 10 / 图 10

Technical Data

Electrical Parameters

Model	HDL-XC62-KV	HDL-NS83-KV	HDL-NW82-KV	HDL-SIW82
Product name	Rhythmus Ceiling Speaker XC62	Rhythmus Ceiling Speaker NS83	Rhythmus Wall Speaker NW82	Rhythmus Wall Speaker SIW82
Woofers	6.5" Kevlar	8" Kevlar	8" Kevlar	8" Paper
Tweeter	1" Ferrofluid cooled silk dome in swivel mount	Dual 3/4" Ferrofluid cooled silk dome	1" Ferrofluid cooled silk dome in swivel mount, +/- 3dB Treble Switch	-
Impedance	8 Ω	8 Ω	8 Ω	8 Ω
Sensitivity	87dB@1W/1M	89dB@1W/1M	87dB@1W/1M	89dB@1W/1M
Power handling	120W	150W	150W	240W
Frequency response	50-20kHz	30-20kHz	30-20kHz	45-500Hz

Environmental Conditions

Working temperature	-5°C~45°C
Working relative humidity	≤90%
Storage temperature	-20°C~60°C
Storage relative humidity	≤93%

Product Specifications

Dimensions	250x144(mm)	278x100mm	262x355x91.5mm	290x480x103mm
Cutout dimensions	210mm	252mm	332x240mm	260x450mm
Mounting depth	135mm	97mm	88mm	91mm
Net weight	1.9 kg	2.9 kg	3.18kg	4.53kg
Housing material	Kevlar, silk dome	Kevlar, silk dome	Kevlar, silk dome	Paper, silk dome
Installation	In-ceiling mounting	In-ceiling mounting	In-wall mounting	In-wall mounting
Protection rating (Compliant to EN 60529)	IP20			

Name and content of harmful substances in products

Harmful substances	Part components		
	Polymer	Metal	Composite materials
Lead (Pb)	o	o	o
Mercury (Hg)	o	o	o
Cadmium (Cd)	o	o	o
Cr, VI	o	o	o
Poly-brominated biphenyls (PBB)	o	o	o
Poly-brominated diphenyl ethers (PBDE)	o	o	o

The circle symbol "o" indicates that the content of the harmful substances in all the homogeneous materials of the component complies with the requirements stated in Annex II of RoHS Directive 2011/65/EU.

技术参数

电气参数:

型号	HDL-XC62-KV	HDL-NS83-KV	HDL-NW82-KV	HDL-SIW82
产品名称	律动系列吸顶音箱XC62	律动系列吸顶音箱NS83	律动系列墙壁音箱NW82	律动系列墙壁音箱SIW82
低音	6.5" Kevlar盆	8" Kevlar盆	8" Kevlar盆	8" 纸盆
高音	1" 丝膜, 可旋转	双音圈, 3/4" 丝膜	1" 丝膜, +/- 3dB高音调节开关	-
阻抗	8 Ω	8 Ω	8 Ω	8 Ω
灵敏度	87dB@1W/1M	89dB@1W/1M	87dB@1W/1M	89dB@1W/1M
功率	120W	150W	150W	240W
频率响应	50-20kHz	30-20kHz	30-20kHz	45-500Hz

环境条件:

工作温度	-5°C~45°C
工作相对湿度	≤90%
储存温度	-20°C~60°C
储存相对湿度	≤93%

产品规格:

尺寸	250x144(mm)	278x100mm	262x355x91.5mm	290x480x103mm
开孔尺寸	210mm	252mm	332x240mm	260x450mm
安装深度	135mm	97mm	88mm	91mm
净重	1.9 kg	2.9 kg	3.18kg	4.53kg
外壳材质	Kevlar盆, 丝膜	Kevlar盆, 丝膜	Kevlar盆, 丝膜	纸盆, 丝膜
安装方式	吸顶式安装	吸顶式安装	嵌入墙壁式安装	嵌入墙壁式安装
防护级别(符合 EN 60529)	IP20			

产品中有害物质的名称及含量

有害物质	零部件		
	聚合物	金属	合成材料
铅(Pb)	o	o	o
汞(Hg)	o	o	o
镉(Cd)	o	o	o
六价铬(Cr, VI)	o	o	o
多溴联苯(PBB)	o	o	o
多溴二苯醚(PBDE)	o	o	o

圆圈符号“o”, 表示该有害物质在该部件所有均质材料中的含量符合2011/65/EU欧盟RoHS指令附录II的要求。

技术支持

服务热线: 020-84651666-7094

(工作时间: 9:00-12:00, 13:00-18:00, 星期一至星期五)

邮箱: kfb@hdlchina.com.cn

网址: <http://www.hdlchina.com>

Technical support

Skype: hdl_support3

E-mail: support@hdlchina.com.cn

Website: <https://www.hdlautomation.com>