

HDL-MP1(2-3)B+MPPI4R/Titan.48 Titan/1(2-3) Buttons Panel(-B) (4CH5A Relay)
 方逸/1(2-3)按键面板(-B) (4CH5A 继电器)
 HDL-MP2(4-6)S+MPPI4R/Titan.48 Titan/2(4-6) Buttons Panel(-A) (4CH5A Relay)
 方逸/2(4-6)按键面板(-A) (4CH5A 继电器)

buspro

Datasheet
产品说明书

Issued: October 19, 2018
 发布: 2018年10月19日
 Edition V1.0.0



Figure 1. HDL-MP1B/Titan.48 图1. 方逸/1按键面板
 Figure 2. HDL-MP2B/Titan.48 图2. 方逸/2按键面板-B
 Figure 3. HDL-MP2S/Titan.48 图3. 方逸/2按键面板-A
 Figure 4. HDL-MP3B/Titan.48 图4. 方逸/3按键面板
 Figure 5. HDL-MP4S/Titan.48 图5. 方逸/4按键面板
 Figure 6. HDL-MP6S/Titan.48 图6. 方逸/6按键面板



Take HDL-MP3B/Titan.48 as an example
 Figure 7. Dimension - Front View
 图7. 尺寸图 - 正面



Figure 8. Front View 图8. 正面图
 Figure 9. Front View 图9. 正面图

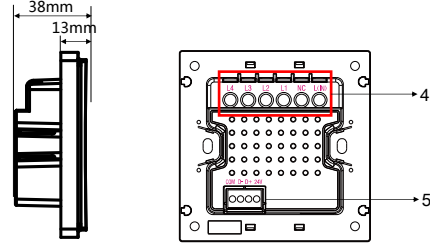

Figure 10. Dimension - Side View 图10. 尺寸图 - 侧面
 Figure 11. Components - Back View 图11. 部件 - 背面图

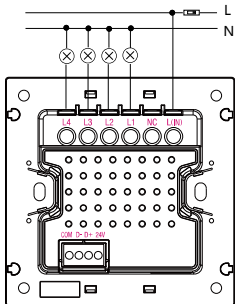

Figure 12. Wiring 图12. 接线图

Overview

Titan Button Panel (See Figure 1-6) is a multi-function control panel with mechanical button which supports various button modes and button control types. Users can customize button labels and control lighting, scene, curtain, music etc. with it.

Relay BCU MPPI4R/Titan.48 (See Figure 10-12) provides working power and communication signal for the panel. With 4 relay output channels, the relay BCU supports load connection.

Functions

Functions of Titan Button Panel

- Button modes: Single on/off, Single on, Single off, Combination on, Combination off, Combination on/off, Double click single on/off, Double click combination on/off, Inching, Short/long press, Short press/long momentary.
- Button control types: Scene, Sequence, Timer Switch, Universal Switch, Single Channel Lighting Control, Broadcast Scene, Broadcast Channel, Curtain Switch, GPRS Control, Panel Control, Security Module, Music Control, General Control, LCD & LED Sleep etc.
- Button Lock, button mutual exclusion
- Customizable button labels
- Adjustable brightness for button status LED indicator
- Backlight color and brightness adjustable
- Online update via HDL Buspro software

Functions of Relay BCU MPPI4R/Titan.48

- Provides working power and communication signal for the panel
- With 4 relay output channels

Important Notes

- The panel must be wall box mounted.
- It is recommended to adopt Buspro Connection - Series connection (hand-in-hand recommended).
- Users can customize the button labels.
- Bus cable - HDL Buspro/KNX cable, 0.8mm single-core copper cable.
- Maximum output current of each relay channel: 5A

Product Information

Dimensions - See Figure 7, 10

Front View - See Figure 8 - 9

Components - See Figure 11

Wiring - See Figure 12

- 1. Button indicator:** Indicates the status of the controlled target.
 - 2. Button:** Control targets.
 - 3. Button label & backlight:** User can customize the button labels according to their preference. Backlight color and brightness adjustable.
 - The relay channels connected to load devices
 - 5. Communication interface:** HDL Buspro interface (from left to right): COM, D-, D+, D+, 24V.
- Address modification:** Keep pressing any button for about 15s, and then all button LED indicators will flash simultaneously, modify the address in HDL-Bus pro Set up software by steps "Address Management > Address Modification", then press any button to exit program mode.
- Panel locking/unlocking:** As shown in Figure 7-9, press Button A1 and A3 for HDL-MP3B/Titan.48, Button A1 and A4 for HDL-MP4S/Titan.48, Button A1 and A6 for HDL-MP6S/Titan.48 for about 2s to lock/unlock the panel.

Product installation and disassembly

(Take HDL-MP1B/Titan.48 as an example)

Installation - See Figure 13 - 15

- Step 1. Fix the base panel into the wall box with screws.
- Step 2. Install the button on the base panel. Ensure the base panel and button are installed tightly.

Disassembly - See Figure 16

- Step 1. Insert the button gap with a slotted screwdriver.
- Step 2. Pry up the button gently, then the button can be taken off.
- Step 3. Unscrew the screws with the screwdriver to disassemble the panel.

Safety Precautions

- The installation and commissioning of the device must be carried out by HDL or the organization designated by HDL. For planning and construction of electric installations, the relevant guidelines, regulations and standards of the respective country are to be considered.
- The device should be wall box mounted. HDL does not take responsibility for all the consequences caused by installation and wire connection that are not in accordance with this document.
- Please do not privately disassemble the device or replace parts, otherwise it may cause mechanical failure, electric shock, fire or body injury.
- Please resort to our customer service department or designated agencies for maintenance service. The warranty is not applicable for the product fault caused by private disassembly.

Package Contents

Panel*1 / Screw*2 / Datasheet*1

产品概述

方逸/按键面板 (见图1-6) 设有机械按键, 支持多种按键模式和按键控制类型。每组按键标签可定制。可实现对灯光、场景、窗帘、音乐等的控制。

继电器面板底座MPPI4R/Titan.48 (见图10-12) 为面板提供工作电源和通讯信号, 同时具有4路继电器输出, 可以连接负载。

功能说明

方逸/按键面板功能

- 按键模式: 单一开/关、单一开、单一关、组合开、组合关、组合开/关、双击/单一开、双击/组合开、点动、短按/长按、短按/长点动
- 按键控制类型: 场景、序列、时间开关、通用开关、单路调节、广播场景、广播回路、窗帘开关、GPRS控制、面板控制、消防模块、音乐控制、通用控制、LCD&LED休眠等
- 按键锁功能、按键互斥功能
- 用户自定义按键标签
- 按键状态灯亮度可调
- 背光灯颜色和亮度可调
- 支持HDL Buspro在线升级

继电器面板底座MPPI4R/Titan.48功能

- 为面板提供工作电源和通讯信号
- 具有4路继电器输出

注意事项

- 面板必须暗盒安装。
- 总线连接 - 推荐使用手拉手的连接方式
- 用户可以定制按键标签
- 总线电缆 - HDL Bus/KNX 专用电缆, 0.8mm单芯铜线
- 每个继电器回路最大输出电流不超过5A

产品信息

产品尺寸 - 见图 7, 10

正面图 - 见图 8 - 9

部件 - 见图 11

产品接线 - 见图 12

- 1. 按键指示灯:** 指示被控目标的状态。
 - 2. 按键:** 控制目标
 - 3. 按键标签&背光灯:** 用户可定制按键标签。背光灯颜色和亮度可调。
 - 继电器回路接负载端
 - 5. 通信接口:** HDL Buspro接口。从左至右: COM, D-, D+, 24V
- 地址修改:** 长按任意一个按键约15秒, 按键灯一起闪烁, 此时可通过“HDL-Bus系统控制软件”的“地址管理→地址修改”对该模块进行地址设置, 再按任意一个按键, 按键指示灯停止闪烁, 退出设置。
- 面板锁定/解锁:** 如图7-9所示, 同时按按键 (HDL-MP3B/Titan.48: A1和A3按键, HDL-MP4S/Titan.48: A1和A4按键, HDL-MP6S/Titan.48: A1和A6按键) 约2秒, 可锁定/解锁面板。

设备的安装和拆卸

(以HDL-MP1B/Titan.48为例)

安装 - 见图 13-15

- 步骤1. 用螺丝将面板底座固定在暗盒里。
- 步骤2. 将按键安装在面板底座上。确保面板底座与按键安装严实。

拆卸面板 - 见图 16

- 步骤1. 用一字螺丝批插入按键缝隙。
- 步骤2. 轻撬按键并取下。
- 步骤3. 用螺丝批拧松螺丝即可拆卸面板。

安全警告

- 本设备的安装及调试工作必须由我司或我司指定的机构进行。其电气安装的计划和施工, 必须遵守当地相关的安全标准和法规。
- 该产品需暗盒安装, 未按照本说明书进行安装及接线方式的, 所造成的一切后果皆与我司无关。
- 请不要私自拆装或更换零部件, 否则可能会导致机械故障、电击、火灾或身体伤害。
- 请将一切维修工作交由我司售后部门或指定机构进行, 本产品的保修范围不适用于因用户拆卸产品而导致的故障。

装箱清单

面板*1 / 螺丝*2 / 说明书*1

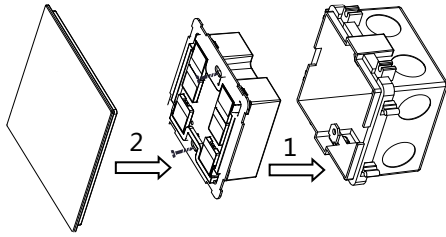

Figure 15 / 图 15 Figure 14 / 图 14 Figure 13 / 图 13

Figure 13 - 15. Installation
图 13 - 15. 安装图

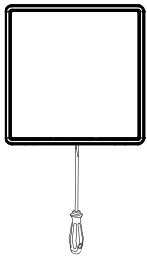

Figure 16. Disassembly
图 16. 安装图

EN

Technical Data

Electrical Parameters

Buspro working voltage	12~30V DC
Power consumption	MP1B+MPPI4R/Titan.48: 75mA/24V DC MP2B+MPPI4R/Titan.48: 75mA/24V DC MP2S+MPPI4R/Titan.48: 75mA/24V DC MP3B+MPPI4R/Titan.48: 80mA/24V DC MP4S+MPPI4R/Titan.48: 80mA/24V DC MP6S+MPPI4R/Titan.48: 90mA/24V DC
Relay load voltage	220V AC
Relay output channel	4CH
Maximum output current	5A/CH
Communication	HDL Buspro
Buspro terminal	0.6 - 0.8mm single core cable

External Environment

Working temperature	-5°C~45°C
Working relative humidity	≤90%
Storage temperature	-20°C~60°C
Storage relative humidity	≤93%

Specifications

Dimensions	92×92×38(mm)
Net weight (with Relay BCU)	145g
Housing material	PC
Installation	Wall box (See Figure 13 - 15)
Protection rating (Compliant with EN 60529)	IP20

Name and Content of Hazardous Substances in Products

Components	Hazardous substances					
	Lead (Pb)	Mercury (Hg)	Cadmium (Cd)	Chromium VI (Cr (VI))	Poly-brominated biphenyls (PBB)	Poly-brominated diphenyl ethers (PBDE)
Plastic	o	o	o	o	o	o
Hardware	o	o	o	o	-	-
Screw	o	o	o	x	-	-
Solder	x	o	o	o	-	-
PCB	x	o	o	o	o	o
IC	o	o	o	o	x	x

The symbol "-" indicates that the hazardous substance is not contained.

The symbol "o" indicates that the content of the hazardous substances in all the homogeneous materials of the component is below the limit requirement specified in the Standard IEC62321-2015.

The symbol "x" indicates that the content of the hazardous substance in at least one of the homogeneous materials of the part exceeds the limit requirement specified in the Standard IEC62321-2015.

HDL Buspro Cable Guide

CAT5/CAT5E	HDL Buspro	HDL Buspro/KNX
Brown/ Orange	24V DC	Red
Brown white/ Orange white	COM	Black
Blue white/Green white	DATA-	White
Blue/ Green	DATA+	Yellow

ZH

技术参数

电气参数

总线工作电压	12~30V DC
总线耗电	MP1B+MPPI4R/Titan.48: 75mA/24V DC MP2B+MPPI4R/Titan.48: 75mA/24V DC MP2S+MPPI4R/Titan.48: 75mA/24V DC MP3B+MPPI4R/Titan.48: 80mA/24V DC MP4S+MPPI4R/Titan.48: 80mA/24V DC MP6S+MPPI4R/Titan.48: 90mA/24V DC
继电器负载电压	220V AC
继电器输出回路	4路
最大输出电流	5A/路
通信协议	HDL Buspro
总线接线端子	0.6-0.8mm单芯电缆

外部环境

工作温度	-5°C~45°C
工作相对湿度	≤90%
储存温度	-20°C~60°C
储存相对湿度	≤93%

产品规格

尺寸	92×92×38(mm)
净重 (含继电器面板底座)	145g
外壳材料	PC
安装方式	暗盒安装 (见图13-15)
防护级别 (符合 EN 60529)	IP20

产品中有害物质的名称及含量

部件名称	有害物质					
	铅 (Pb)	汞 (Hg)	镉 (Cd)	六价铬 (Cr (VI))	多溴联苯 (PBB)	多溴二苯醚 (PBDE)
塑胶组件	o	o	o	o	o	o
五金铜件	o	o	o	o	-	-
螺丝组件	o	o	o	x	-	-
焊锡	x	o	o	o	-	-
PCB组件	x	o	o	o	o	o
IC	o	o	o	o	x	x

- : 表示不含有该有害物质。

o : 表示该有害物质在该部件所有均质材料中的含量均在IEC62321-2015规定的限量要求以下。

x : 表示该有害物质至少在该部件的某一均质材料中的含量超出IEC62321-2015规定的限量要求。

总线定义

CAT5/CAT5E	HDL Buspro	HDL Buspro/KNX
棕/橙	24V DC	红
棕白/橙白	COM	黑
蓝白/绿白	DATA-	白
蓝/绿	DATA+	黄

技术支持

服务热线: 020-85820195

(工作时间: 9:00-12:00, 13:00-18:00, 星期一至星期五)

邮箱: kfb@hdlchina.com.cn

网址: http://www.hdlchina.com

Technical support

E-mail: support@hdlchina.com.cn

Website: https://www.hdlautomation.com

©Copyright by HDL Automation Co., Ltd. All rights reserved.
Specifications subject to change without notice.